



AU-108MHB



Lower power
loss



Lower temperature
coefficient



Better performance in
lower light environment



Lower shipping cost
on per watt



Lower leveled cost
on energy

Unit:mm

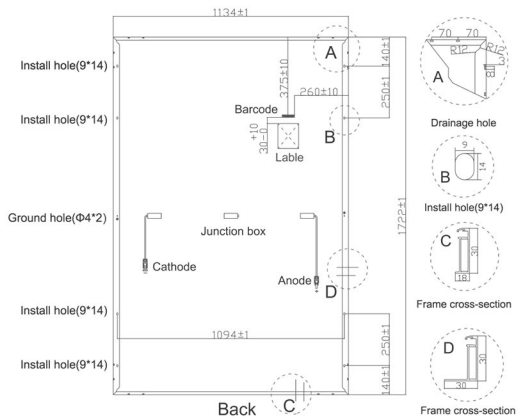
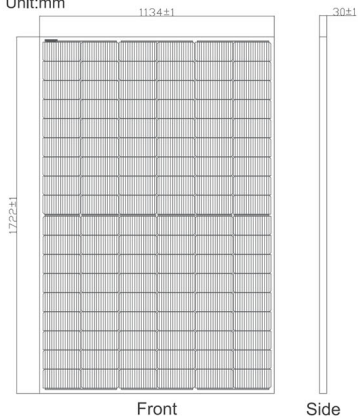

IV CURVE

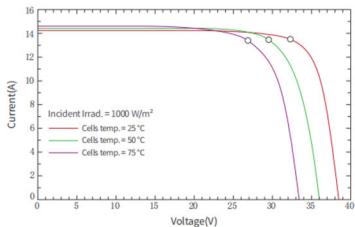
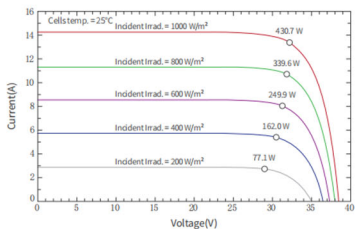

WARRANTY

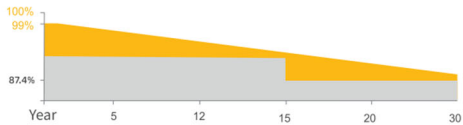

Technical Specifications and Performance Data					
Model type	AU420-27V-MHB	AU425-27V-MHB	AU430-27V-MHB	AU435-27V-MHB	AU440-27V-MHB
Peak Power (Pmax)	420.00	425.00	430.00	435.00	440.00
Maximum Power Voltage (Vmp)	31.71	31.90	32.08	32.26	32.44
Maximum Power Current (Imp)	13.25	13.32	13.40	13.48	13.56
Open Circuit Voltage (Voc)	38.31±3%	38.50±3%	38.69±3%	38.87±3%	39.05±3%
Short Circuit Current (Isc)	13.99±3%	14.06±3%	14.14±3%	14.21±3%	14.29±3%
Module Efficiency (%)	21.51	21.76	22.02	22.28	22.54
Power Tolerance			0~+3W		
Pmax Temperature Coefficients (W/°C)			-0.300%/°C		
Voc Temperature Coefficients (V/°C)			-0.250%/°C		
Isc Temperature Coefficients (A/°C)			+0.048%/°C		
NOCT Nominal Operating Cell Temperature (°C)			45±2°C		
Operating and Storage Temperature (°C)			-40w~+85°C		
Standard Test Condition (STC)			1000W/m2,AM1.5,25±2°C		
Cell Type	182"91 H-Type Black Mono				
No. of Cells	108(12"9)				
Dimensions(mm)	1722*1134*30mm				
Weight	21.50kg				
Front Glass(mm)	3.2mm high transmission,low iron,tempered glass				
Frame	Anodized Aluminium Alloy				
Maximum System Voltage (V)	1500V				
Maximum Series Fuse Rating(A)	25 A				
Junction box	IP68 3diodes				
Output cables	4mm2 cable 90cm (including MC4 connector)				
MaxWind Load/Snow Load	2400Pa/5400Pa				
20FT container	6 Packages/222pcs				
40HQ container	26 Packages/962pcs				



AU-108MHBD



Lower power
loss



Lower temperature
coefficient



Higher double-sided
revenue



Better performance in
lower light environment



Lower shipping cost
on per watt



Lower levelized cost
on energy

Model type	AU420-27V-MHBD	AU425-27V-MHBD	AU430-27V-MHBD	AU435-27V-MHBD	AU440-27V-MHBD
Peak Power (Pmax)	420.00	425.00	430.00	435.00	440.00
Maximum Power Voltage (Vmp)	31.71	31.90	32.08	32.26	32.44
Maximum Power Current (Imp)	13.25	13.32	13.40	13.48	13.56
Open Circuit Voltage (Voc)	38.31±3%	38.50±3%	38.69±3%	38.87±3%	39.05±3%
Short Circuit Current (Isc)	13.99±3%	14.06±3%	14.14±3%	14.21±3%	14.9±3%
Module Efficiency (%)	21.51	21.76	22.02	22.28	22.54
Power Tolerance	0→+3W				
Pmax Temperature Coefficients (W/°C)	-0.300%/°C				
Voc Temperature Coefficients (V/°C)	-0.250%/°C				
Isc Temperature Coefficients (A/°C)	+0.046%/°C				
NOCT Nominal Operating Cell Temperature (°C)	45±2°C				
Operating and Storage Temperature (°C)	-40~+85°C				
Standard Test Condition (STC)	1000W/m2,AM1.5,25±1-2°C				
Cell Type	162"91 N-Type Black Mono				
No of Cells	108(12*9)				
Dimensions(mm)	1722*1134*30mm				
Weight	24.70kg				
Front Glass(mm)	2.0mm high transmission,low iron,tempered glass				
Back Glass(mm)	2.0mm Glazed Glass				
Frame	Anodized Aluminium Alloy				
Maximum System Voltage (V)	1500V				
Maximum Series Fuse Rating(A)	30 A				
Junction box	IP68 3diodes				
Output cables	4mm ² cable 90cm (Including MC4 connector)				
MaxWind Load/Snow Load	2400Pa/5400Pa				
20FT container	6 Packages/222pcs				
40HQ container	26 Packages/962pcs				

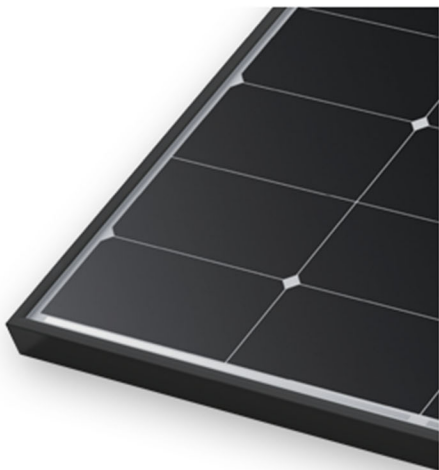

AU-108MH



Lower power
loss



Lower temperature
coefficient



Better performance in
lower light environment



Lower shipping cost
on per watt



Lower levelized cost
on energy

Model type	AU415-27V-MH	AU420-27V-MH	AU426-27V-MH	AU430-27V-MH	AU435-27V-MH	AU440-27V-MH
ELECTRICAL DATA(STC)						
Peak Power(Pmax)	415.00	420.00	425.00	430.00	435.00	440.00
Maximum Power Voltage (Vmp)	32.24	32.44	32.64	32.84	33.04	33.24
Maximum Power Current (Imp)	12.88	12.95	13.03	13.10	13.17	13.24
Open Circuit Voltage (Voc)	38.53±3%	38.73±3%	38.93±3%	39.13±3%	39.33±3%	39.53±3%
Short Circuit Current (Isc)	13.92±3%	14.00±3%	14.07±3%	14.15±3%	14.22±3%	14.29±3%
Module Efficiency (%)	21.26	21.51	21.77	22.03	22.28	22.54
ELECTRICAL DATA(NOCT)						
Peak Power(Pmax)	310.00	314.00	318.00	321.00	325.00	329.00
Maximum Power Voltage(Vmp)	29.42	29.60	29.78	29.97	30.15	30.33
Maximum Power Current(Imp)	10.54	10.60	10.67	10.72	10.78	10.85
Open Circuit Voltage(Voc)	36.18±3%	36.36±3%	36.55±3%	36.74±3%	36.93±3%	37.12±3%
Short Circuit Current(Isc)	11.24±3%	11.31±3%	11.36±3%	11.43±3%	11.49±3%	11.56±3%
TEMPERATURE MAXIMUM RATING						
Maximum System Voltage(V)	1500V					
Maximum Series Fuse Rating(A)	25A					
Power Tolerance	0→+3W					
Pmax Temperature Coefficients(W/°C)	-0.290%/°C					
Voc Temperature Coefficients(V/°C)	-0.230%/°C					
Isc Temperature Coefficients(A/°C)	+0.050%/°C					
NOCT Nominal Operating Cell Temperature(°C)	45±2°C					
Operating and Storage Temperature(°C)	-40→+85°C					
MECHANICAL CHARACTERISTICS						
Cell Type	182*91 HPBC Mono					
No of Cells	108(12*9)					
Dimensions	1722*1134*30mm					
Weight	20.80kg					
Front Glass	3.2mm high transmission,low iron,tempered glass					
Frame	Anodized Aluminium Alloy					
Junction box	IP68diodes					
Output cables	4mm2 cable 35cm(Including MC4 connector)					
MaxWind Load/Snow Load	2400Pa/5400Pa					
PACKING WAY						
20FT container	6 Packages/222pcs					
40HQ container	26 Packages/962pcs					

PV DRAWINGS

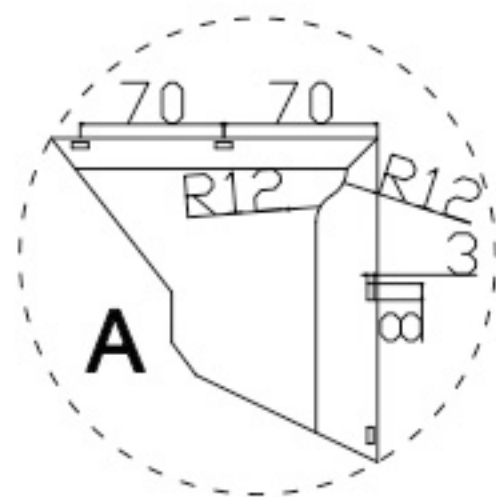
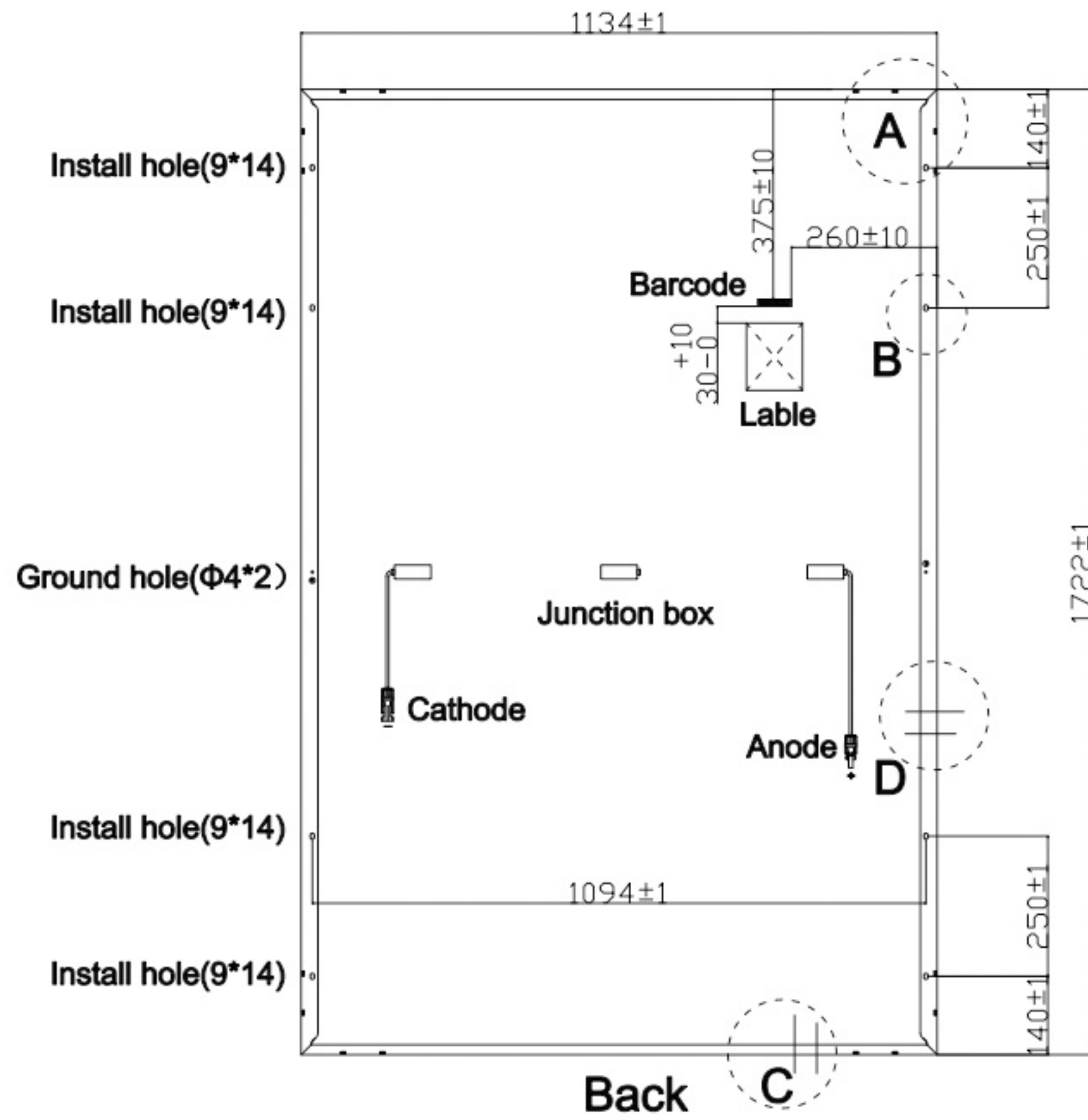

Drainage hole

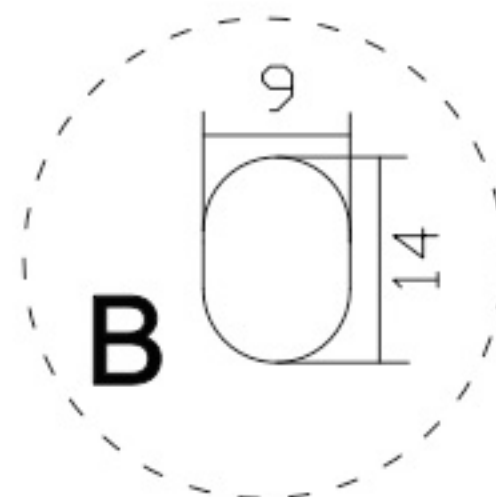

Install hole(9*14)

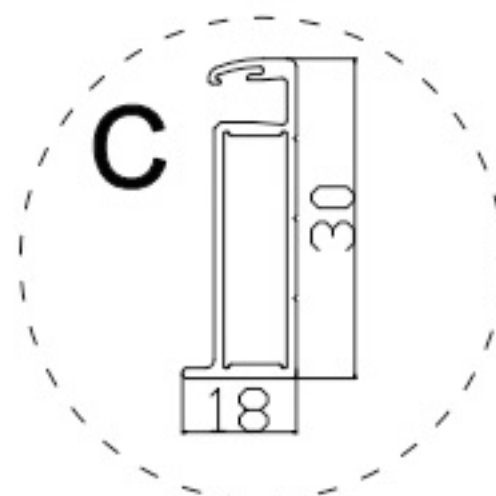

Frame cross-section

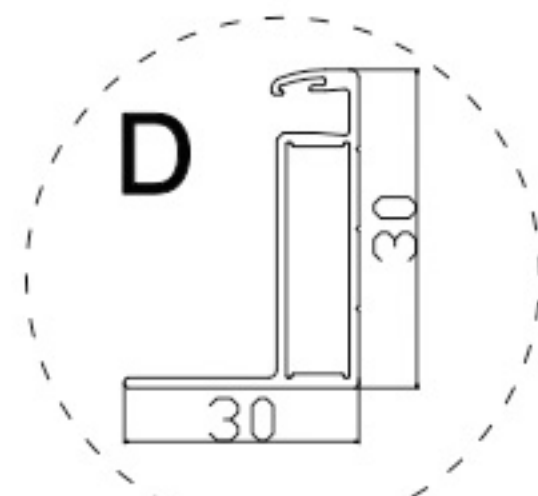

Frame cross-section

IV CURVE (440W)

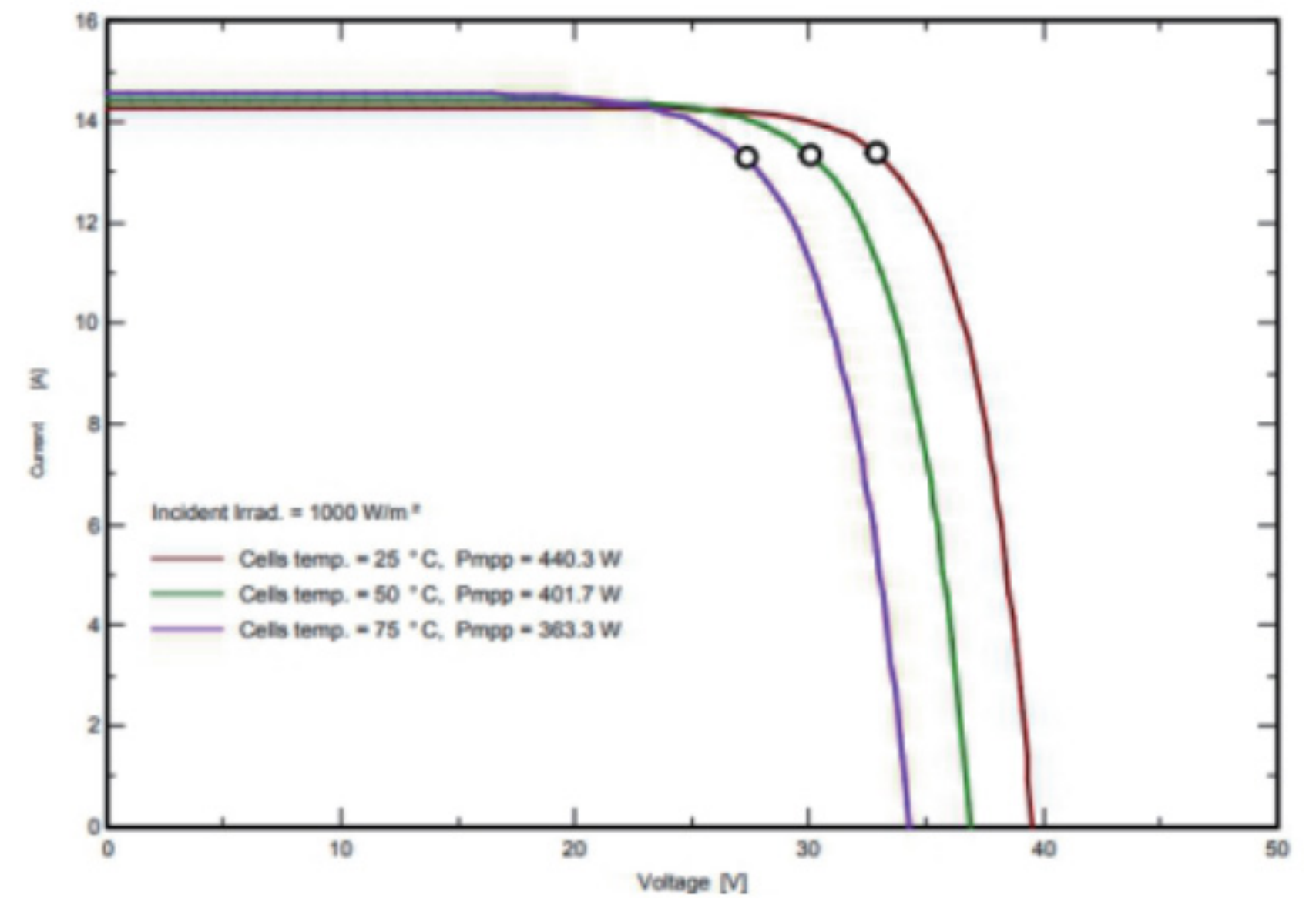
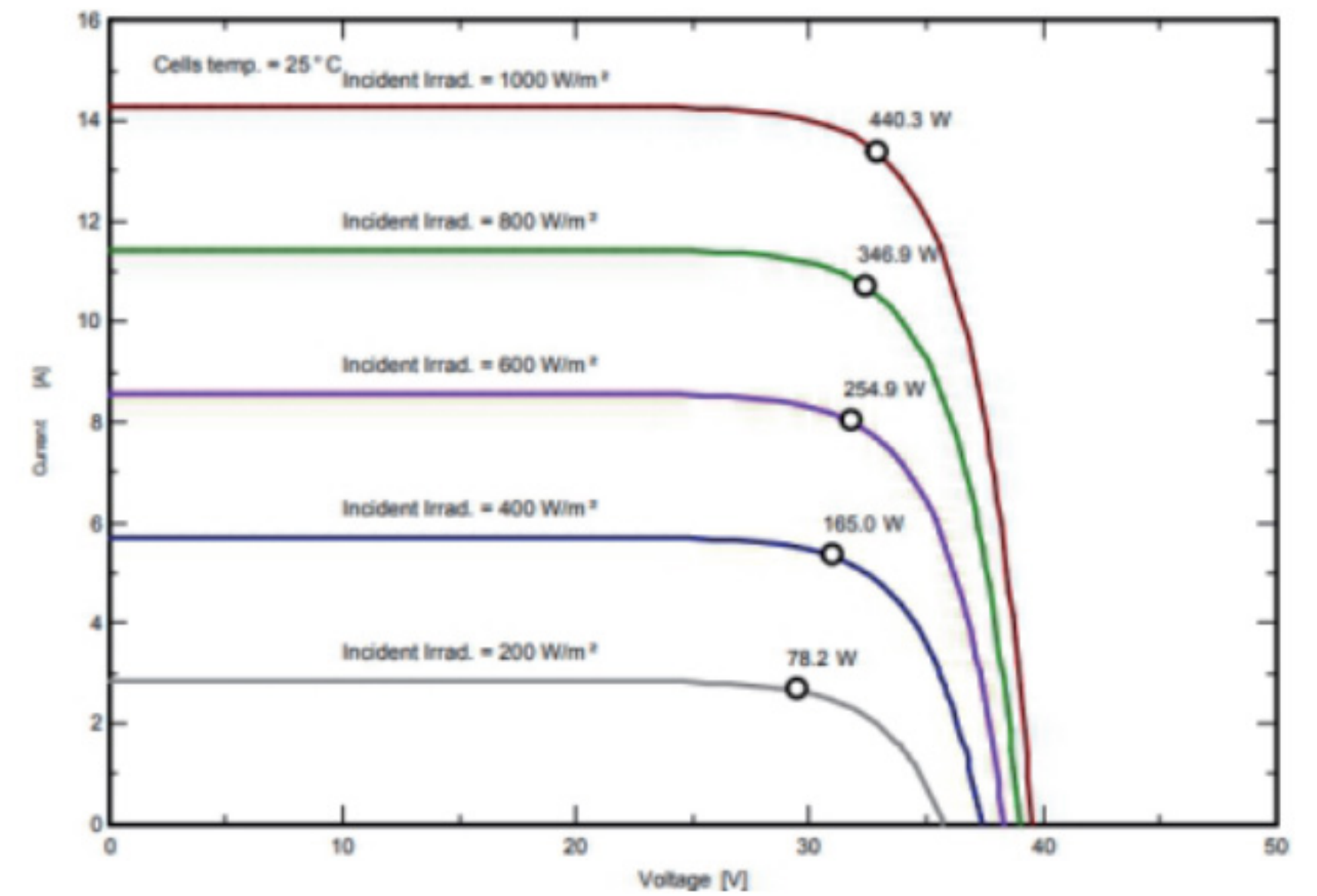



AU-108MHB



Lower power
loss



Lower temperature
coefficient



Better performance in
lower light environment



Lower shipping cost
on per watt



Lower levelized cost
on energy

Model type	AU410-27V-MH-B	AU416-27V-MH-B	AU420-27V-MH-B	AU426-27V-MH-B	AU430-27V-MH-B	AU436-27V-MH-B
ELECTRICAL DATA(STC)						
Peak Power(Pmax)	410.00	415.00	420.00	425.00	430.00	435.00
Maximum Power Voltage (Vmp)	32.36	32.56	32.76	32.96	33.16	33.36
Maximum Power Current (Imp)	12.67	12.75	12.83	12.90	12.97	13.03
Open Circuit Voltage (Voc)	38.63±3%	38.83±3%	39.03±3%	39.23±3%	39.43±3%	39.63±3%
Short Circuit Current (Isc)	13.70±3%	13.78±3%	13.85±3%	13.93±3%	14.00±3%	14.07±3%
Module Efficiency (%)	21.00	21.26	21.51	21.77	22.03	22.28
ELECTRICAL DATA(NOCT)						
Peak Power(Pmax)	306.00	310.00	314.00	318.00	321.00	325.00
Maximum Power Voltage(Vmp)	29.53	29.71	29.89	30.08	30.26	30.44
Maximum Power Current(Imp)	10.37	10.44	10.50	10.56	10.78	10.68
Open Circuit Voltage(Voc)	36.27±3%	36.46±3%	36.65±3%	36.83±3%	37.02±3%	37.20±3%
Short Circuit Current(Isc)	11.07±3%	11.13±3%	11.19±3%	11.25±3%	11.31±3%	11.37±3%
TEMPERATURE MAXIMUM RATING						
Maximum System Voltage(V)	1500V					
Maximum Series Fuse Rating(A)	25A					
Power Tolerance	0~+3W					
Pmax Temperature Coefficients(W/°C)	-0.290%/°C					
Voc Temperature Coefficients(V/°C)	-0.230%/°C					
Isc Temperature Coefficients(A/°C)	+0.050%/°C					
NOCT Nominal Operating Cell Temperature(°C)	45±2°C					
Operating and Storage Temperature(°C)	-40~+85°C					
MECHANICAL CHARACTERISTICS						
Cell Type	182*91 HPBC Mono					
No of Cells	108(12*9)					
Dimensions	1722*1134*30mm					
Weight	20.80kg					
Front Glass	3.2mm high transmission,low iron,tempered glass					
Frame	Anodized Aluminium Alloy					
Junction box	IP683diodes					
Output cables	4mm2 cable 35cm(Including MC4 connector)					
MaxWind Load/Snow Load	2400Pa/5400Pa					
PACKING WAY						
20FT container	6 Packages/222pcs					
40HQ container	26 Packages/962pcs					

PV DRAWINGS

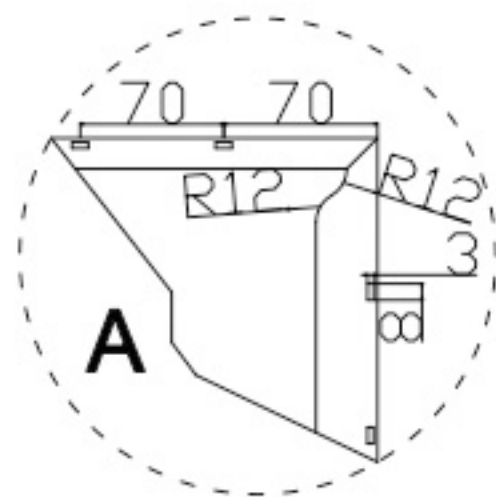
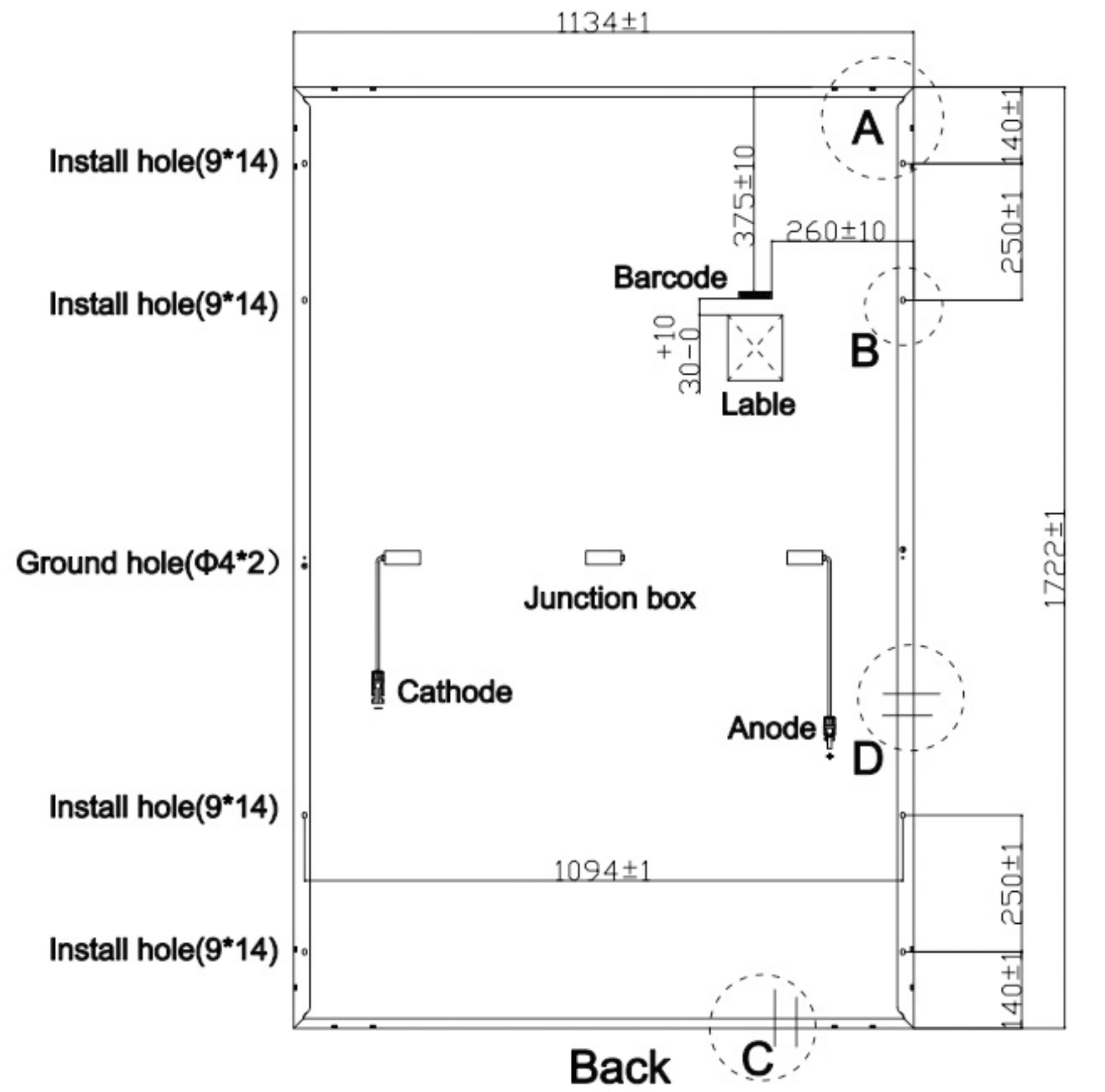

Drainage hole

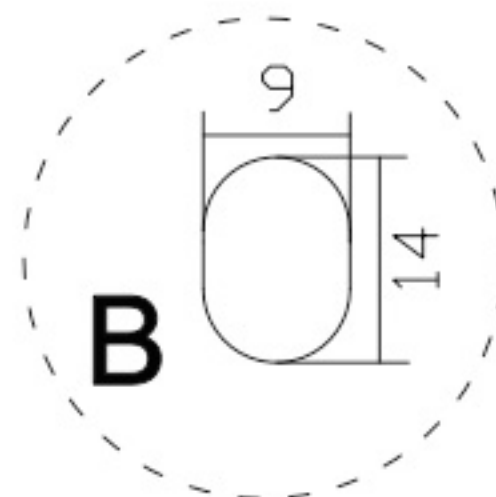

Install hole(9*14)

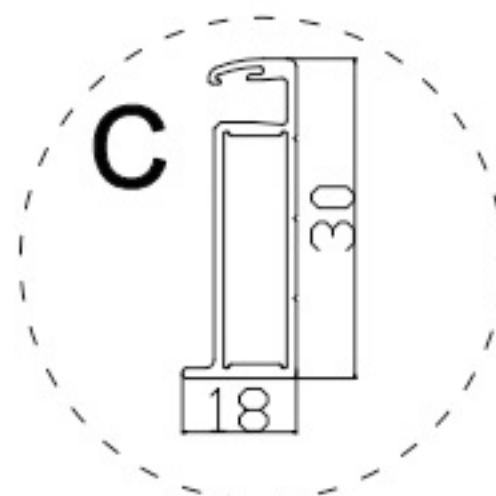

Frame cross-section

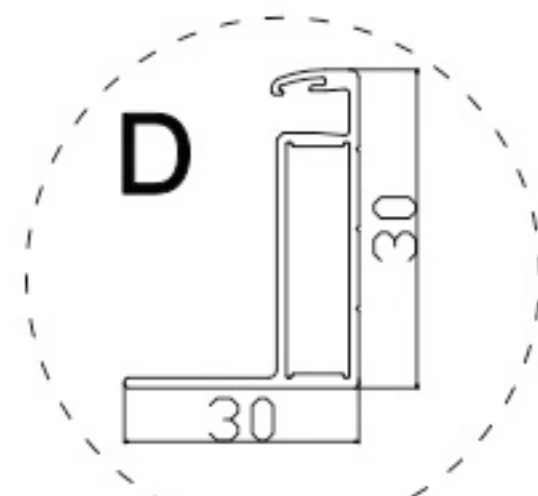

Frame cross-section

IV CURVE (440W)

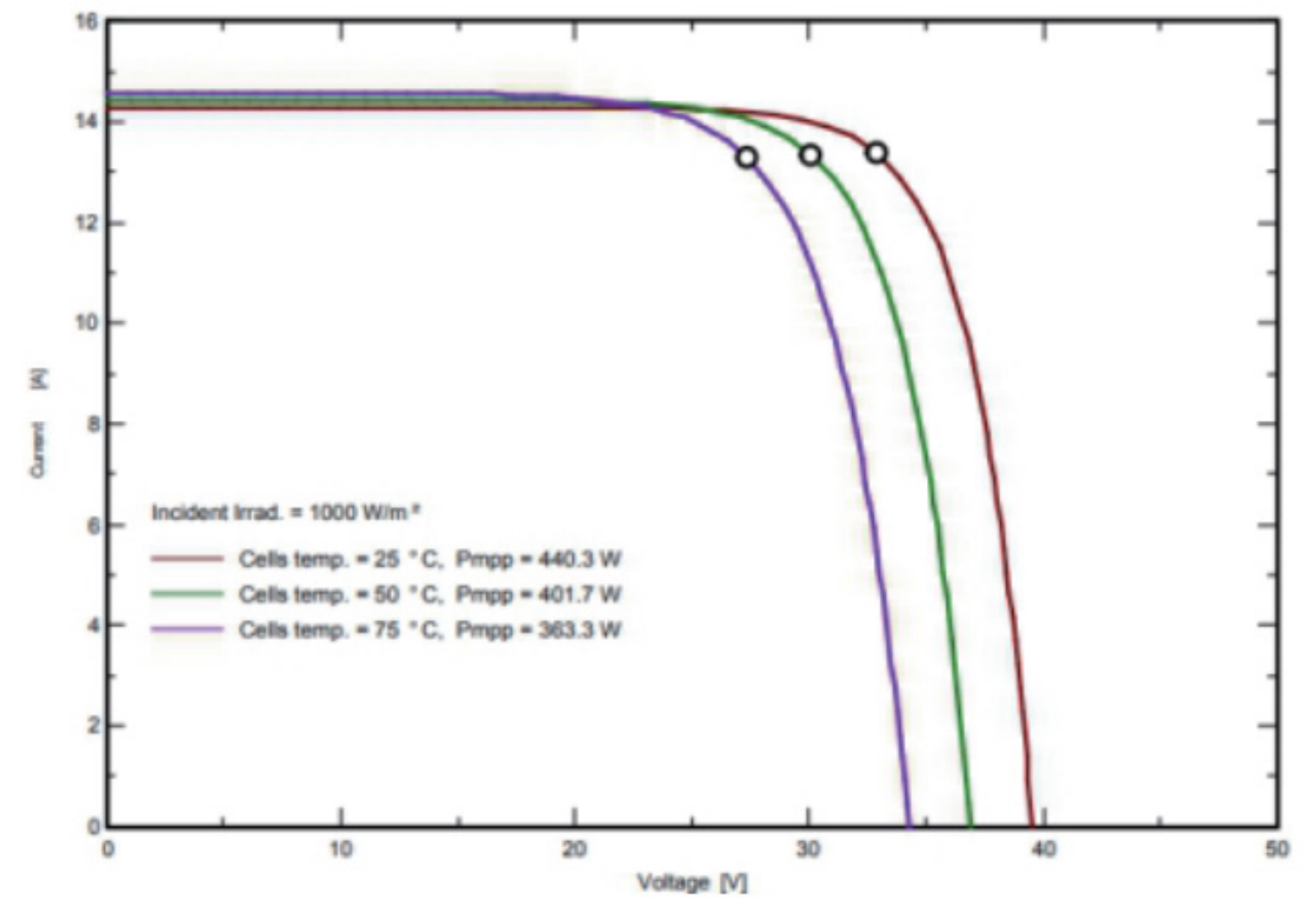
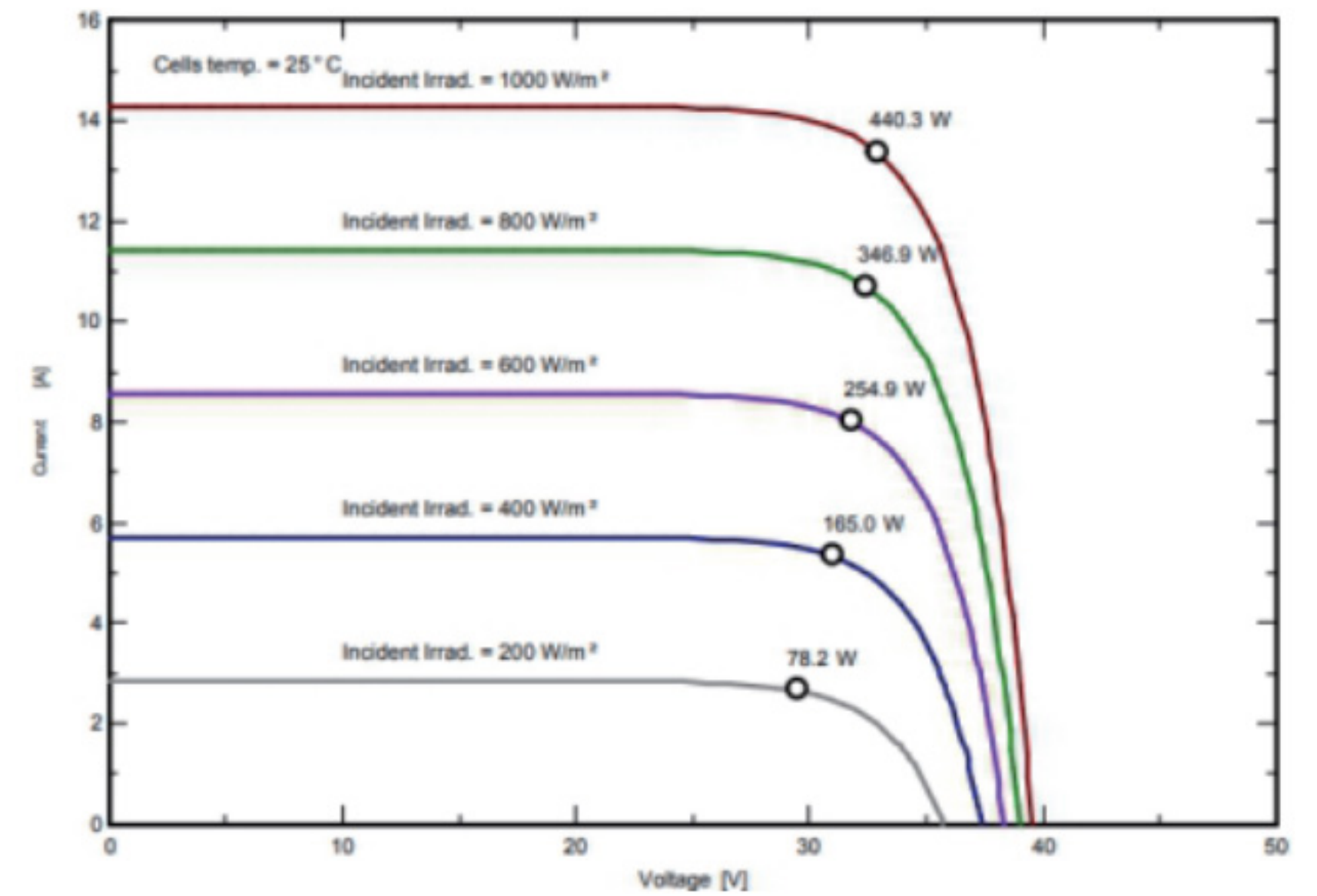

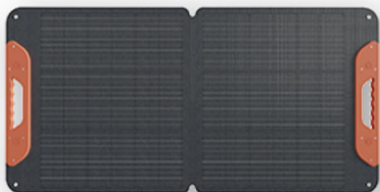

Austa-100/120W-18FB



Foldable



Portable



Outdoor



Optional

Model	Austa-100W-18FB	Austa-120W-18FB
Peak Power (W)	100	120
Maximum Power Voltage (Vmp)	19.6	19.47
Maximum Power Current (Imp)	5.11	6.17
Open Circuit Voltage (Voc)	22.82	22.67
Short Circuit Current (Isc)	5.38	6.49
Folding Dimensions (mm)	585×579	585×650
Unfolding Dimensions (mm)	1168×585	1300×585
Carton Box Size (mm)	675×615×75 (inner box)	
N.W. (KG)	4.5	5.73



Austa-200/240W-18FB



Foldable



Portable



Outdoor



Optional

Model	Austa-200W-18FB	Austa-240W-18FB
Peak Power (W)	200	240
Maximum Power Voltage (Vmp)	19.6	19.47
Maximum Power Current (Imp)	10.21	12.33
Open Circuit Voltage (Voc)	22.82	22.67
Short Circuit Current (Isc)	10.75	12.98
Folding Dimensions (mm)	585×579	585×650
Unfolding Dimensions (mm)	2186×585	2440×585
Carton Box Size (mm)	680×630×80	675×615×95
N.W. (KG)	7.95	10.5



166M Split Cell 100W-110W



Outstanding Mechanical
Load Resistance



Double Electroluminescence
(EL) Tests



Anti-PID (Potential
Induced Degradation)



Great Durability Against
Extreme Conditions

Detailed Parameters		
Model Type	AU100W-18M	AU110W-18M
ELECTRICAL PERFORMANCE		
Dimensions (L / W / H)	1075*540*30	1075*540*30
	STC	STC
Peak Power at STC (Pmax)	100	110
Maximum Power Voltage (Vmp)	18.56	20.12
Maximum Power Current (Imp)	5.39	5.47
Open Circuit Voltage (Voc)	21.92	23.52
Short Circuit Current (Isc)	5.7	5.78
Module Efficiency(%)	17.30	19.03
THERMAL CHARACTERISTICS & OPERATING CONDITIONS		
Maximum System Voltage(V)	1000V	
Maximum Series Fuse Rating(A)	10	
Power Tolerance	0 ~ +3 %	
Pmax Temperature Coefficients(W/°C)	-0.350 %	
Voc Temperature Coefficients(V/°C)	-0.270 %	
Isc Temperature Coefficients(A/°C)	+0.048 %	
NOCT Nominal Operating Cell Temperature(°C)	45±2	
Operating and Storage Temperature(°C)	-40°C ~ +85°C	
CONSTRUCTION MATERIALS		
Front Cover (Material / Thickness)	low-iron tempered glass / 3.2mm	
No. of Cells	36(3*12)	
Frame (Material)	Anodized Aluminium Alloy	
Junction Box (Protection Degree)	IP65/IP67	
Cable (Length/Cross-Sectional Area)	2.5mm² cable 50cm+mc4	
PACKAGING SPECIFICATIONS		
20FT container		
10Packages/1360PCS		
40HQ container		
22Packages/2856PCS		

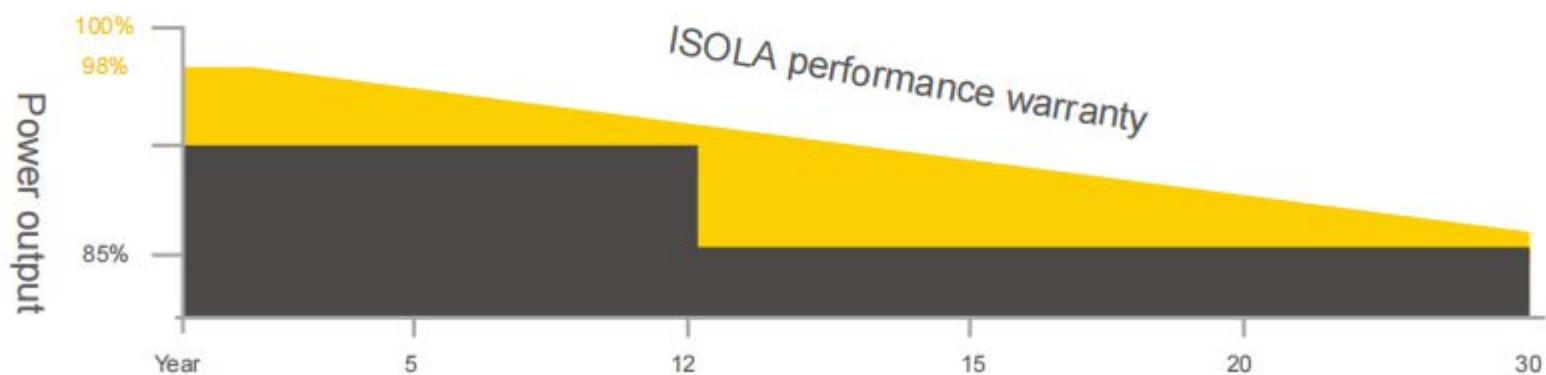
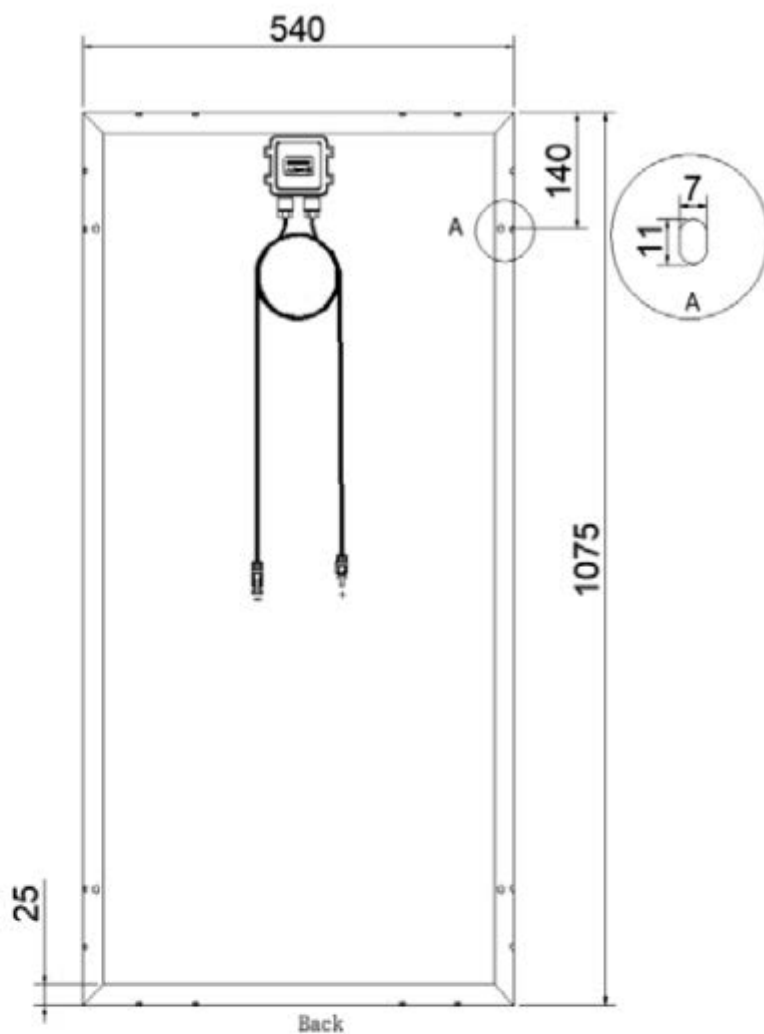
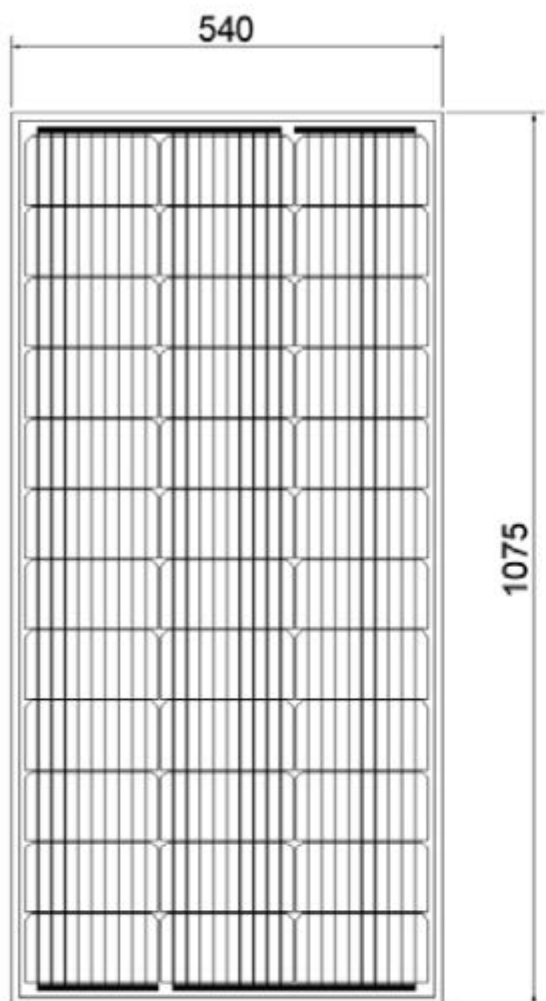



210M Splt Cell 180W–200W



Outstanding Mechanical
Load Resistance



Double Electroluminescence
(EL) Tests



Anti-PID (Potential
Induced Degradation)



Great Durability Against
Extreme Conditions

DETAILED PARAMETERS

Model Type	AU180W-18M	AU190W-18M	AU200W-18M
ELECTRICAL PERFORMANCE			
Dimensions (L / W / H)	1485*668*30	1485*668*30	1485*668*30
	STC	STC	STC
Peak Power at STC (Pmax)	180	190	200
Maximum Power Voltage (Vmp)	21.79	21.86	22.45
Maximum Power Current (Imp)	8.27	8.70	8.91
Open Circuit Voltage (Voc)	24.37	25.62	26.01
Short Circuit Current (Isc)	8.72	9.19	9.41
Module Efficiency(%)	18.99	18.87	20.80
THERMAL CHARACTERISTICS & OPERATING CONDITIONS			
Maximum System Voltage(V)		1000V	
Maximum Series Fuse Rating(A)		10	
Power Tolerance		0 ~ +3 %	
Pmax Temperature Coefficients(W/°C)		-0.350 %	
Voc Temperature Coefficients(V/°C)		-0.270 %	
Isc Temperature Coefficients(A/°C)		+0.048 %	
NOCT Nominal Operating Cell Temperature(°C)		45±2	
Operating and Storage Temperature(°C)		-40°C ~ +85°C	
CONSTRUCTION MATERIALS			
Front Cover (Material / Thickness)		low-iron tempered glass / 3.2mm	
Cell (Quantity/Type/Dimensions)		166*55.33 Mono	
No. of Cells		39(3*13)	
Frame (Material)		Anodized Aluminium Alloy	
Junction Box (Protection Degree)		IP65/IP67	
Cable (Length/Cross-Sectional Area)		2.5mm² cable 50cm+mc4	
PACKAGING SPECIFICATIONS			
20'F container			
7Packages/672PCS			
40'HQ container			
14Packages/1560PCS			

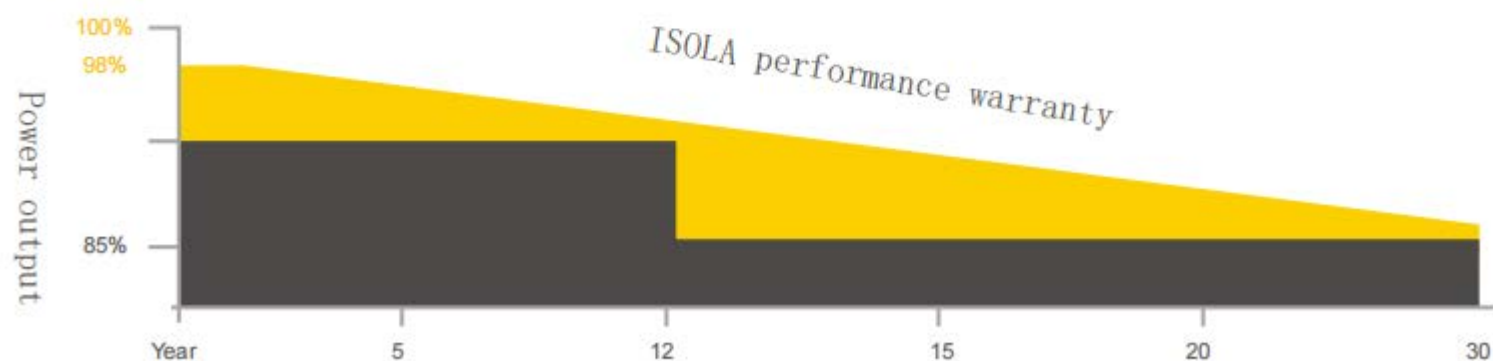
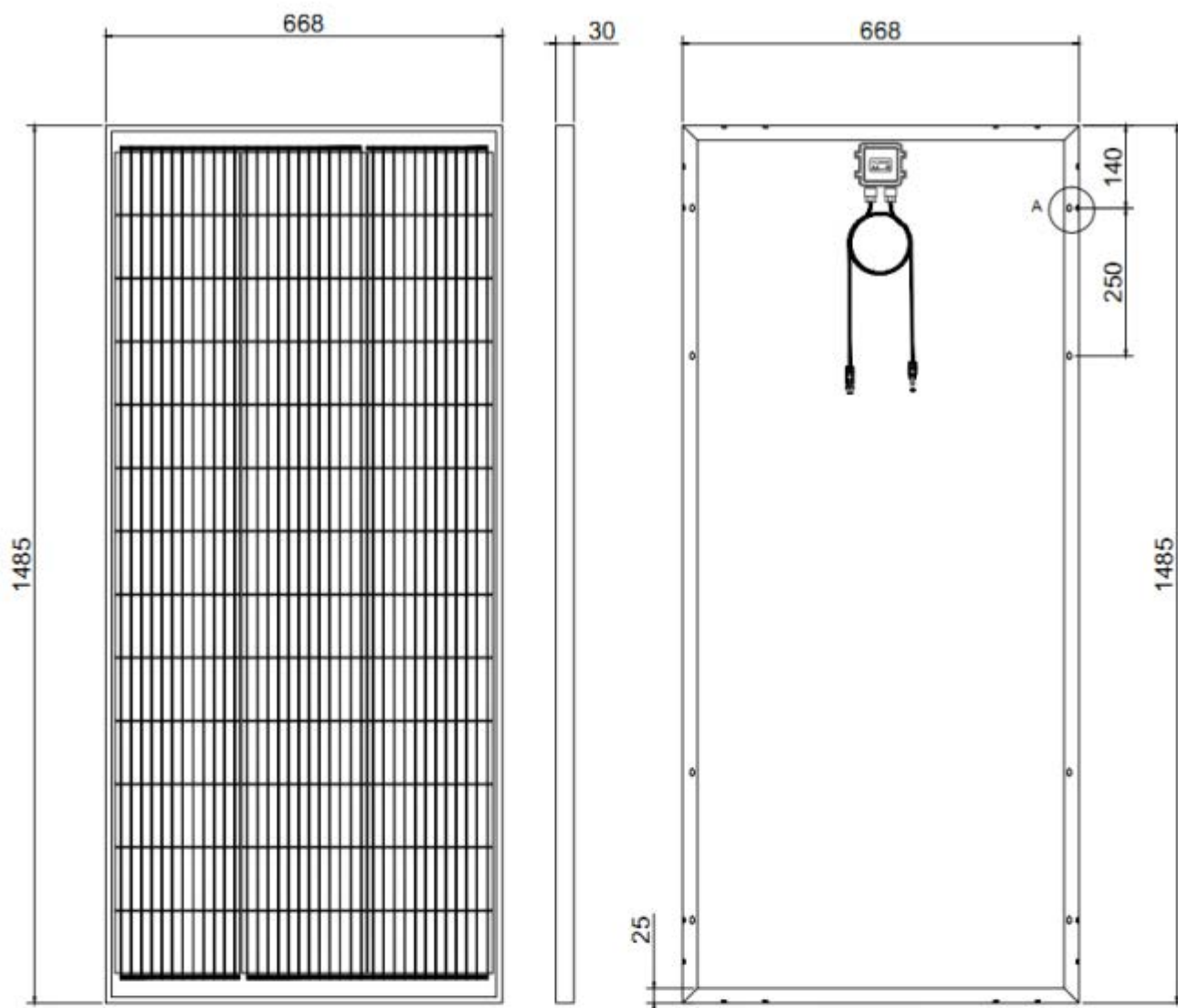



166M Splt Cell 140W–150W



Outstanding Mechanical
Load Resistance



Double Electroluminescence
(EL) Tests



Anti-PID (Potential
Induced Degradation)



Great Durability Against
Extreme Conditions

DETAILED PARAMETERS

Model Type	AU140W-18M	AU150W-18M
ELECTRICAL PERFORMANCE		
Dimensions (L / W / H)	1080*705*30	1080*705*30
	STC	STC
Peak Power at STC (Pmax)	140	150
Maximum Power Voltage (Vmp)	19.85	20.55
Maximum Power Current (Imp)	7.06	7.30
Open Circuit Voltage (Voc)	23.44	23.82
Short Circuit Current (Isc)	7.46	7.69
Module Efficiency(%)	18.39	19.70
THERMAL CHARACTERISTICS & OPERATING CONDITIONS		
Maximum System Voltage(V)	1000V	
Maximum Series Fuse Rating(A)	15	
Power Tolerance	0 ~ +3 %	
Pmax Temperature Coefficients(W/°C)	-0.350 %	
Voc Temperature Coefficients(V/°C)	-0.270 %	
Isc Temperature Coefficients(A/°C)	+0.048 %	
NOCT Nominal Operating Cell Temperature(°C)	45±2	
Operating and Storage Temperature(°C)	-40°C ~ +85°C	
CONSTRUCTION MATERIALS		
Front Cover (Material / Thickness)	low-iron tempered glass / 3.2mm	
Cell (Quantity/Type/Dimensions)	168/55.33 Mono	
No. of Cells	72(4*18)	
Frame (Material)	Anodized Aluminium Alloy	
Junction Box (Protection Degree)	IP65/IP67	
Cable (Length/Cross-Sectional Area)	2.5mm² cable 50cm+mc4	
PACKAGING SPECIFICATIONS		
20FT container		
8Packages/960PCS		
40HQ container		
16Packages/2176PCS		

